

SANDER

Yaşam Alanlarınıza Değer Katar

2023
MODEL EXCLUSIVE TYPE1
WC CUBICLE CATALOGUE
10

SANDER

S
I
N
C
E
2001

Our Brand **Vision**

From Turkey to the World, with **environmental**,
ecological, and national values...

EXPORT TO 26 DIFFERENT COUNTRIES



Since 2001, SANDER, the industry leader, has expanded its production and export volume.

It is a global brand that is continually expanding.

With cubicle manufacture, we specialize in providing comfort to living areas.

"High quality service at an affordable price" has been our motto from the day we opened our doors.

Our enterprise, which operates entirely with local capital and products, generates both employment and significant economic contributions to our country.

A model structure in terms of the significance it places on technology, R&D, design, and human resources.

SANDER, which is a "sustainable" discipline concept, gains an environmental business strategy.

Because of its environmental business strategy, SANDER is a "sustainable" discipline concept. acquires.

SANDER, which continuously decreases its carbon emissions through a regulated follow-up, plans to meet the "zero waste" aim by 2030.

The tagline "Adds value to your living spaces" inspires the design of practical, colorful, and dependable items.

SANDER provides comfort in over 20 nations.

SPECIAL

The **Exclusive Type 1** product line's naturalist lines bring the richness of nature into your living spaces. Her design's features represent natural life and mother earth.

The textural lines in the **Exclusive Type 1** product range add colour and excitement to your living areas. It is ideal for a large mirror and a well-lit living room. They work well along with metal components.

When you pick this product, the **Exclusive Type 1** characteristics give a calm atmosphere by absorbing high frequency sounds. Comfort allows you to select items that meet your expectations, audience, and preferences.

MODEL EXCLUSIVE TYPE 1
Product Code: 10109A012



Value Adding **Features**

Quality details and advantages;

- Our panels are 12 mm thick and water and humidity resistant.
- Our panels are antibacterial and feature easy-to-clean surfaces.
- Our cabins' panels and fasteners are certified.
- This product line makes use of first-rate album raw materials.
- Satin stainless steel is used to make connection, support, and complimentary pieces (SSS 304 quality).
- Steel materials have received a unique coating (SSS permalast) that improves corrosion resistance.
- Product line of the SANDER Exclusive Type 1 series.
- Produced with cutting-edge technology and engineering expertise.
- It has been designed with the notion of adding value to living spaces in mind.
- Designs that were unique, innovative, and colorful were employed.
- Water, humidity, heat, and cold have no effect on it.
- It has a strong abrasion resistance.
- It is entirely made in Turkiye.
- It creates direct jobs and contributes to the Turkish economy.
- Customer satisfaction is prioritized both before and after the transaction.
- The choice is yours: We can also produce steel accessories in the quality of SSS 316.

Comfort is in the details.

With A Three-Dimensional Perspective
PRECISE DETERMINATION, AND DEFINITIVE SOLUTION

TOP VIEW

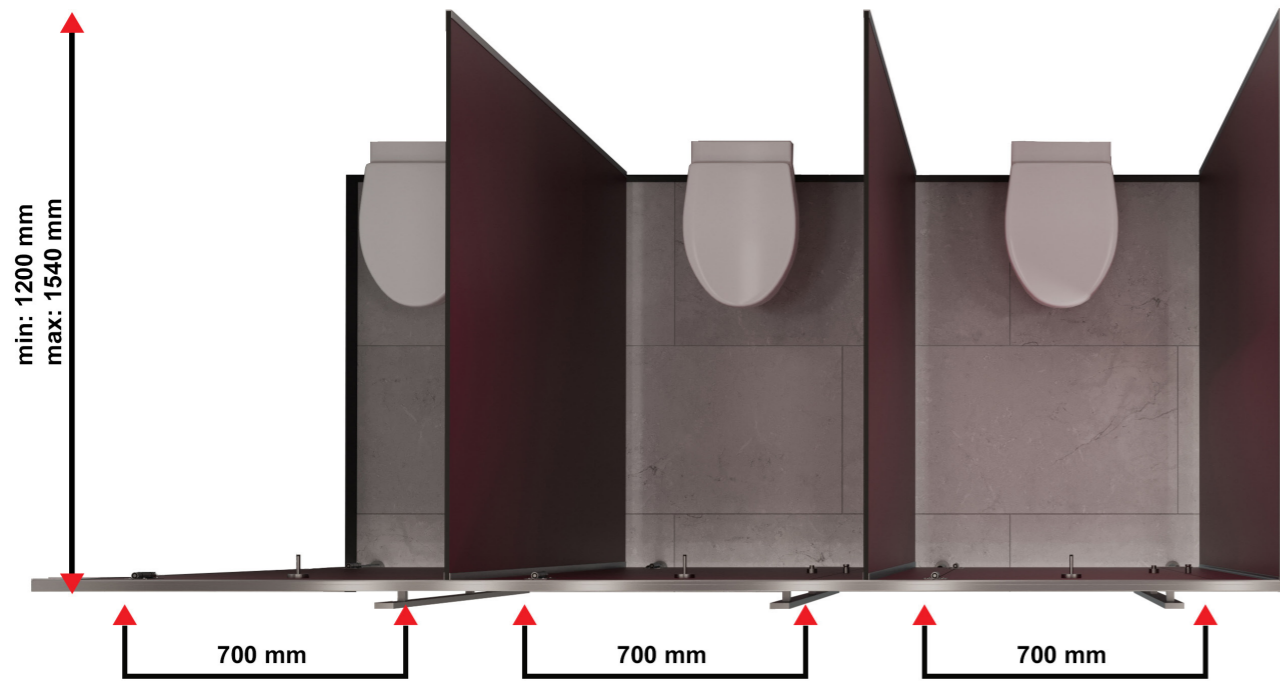

FRONT VIEW



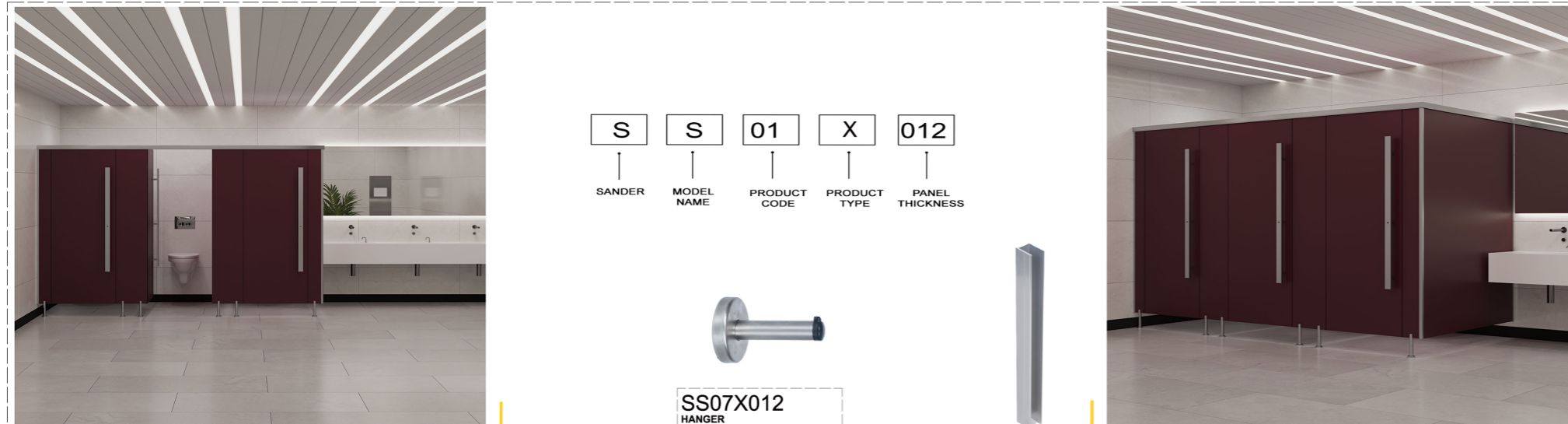

S

SANDER

S

MODEL NAME

01

PRODUCT CODE

X

PRODUCT TYPE

012

PANEL THICKNESS

SS07X012
HANGER

- It's made of 304 quality stainless steel.
- It is corrosion-free within the guarantee term.
- Water and humidity resistant.
- Plastic material is added at the product's end to serve as a stopper and prevent impacts.
- It is capable of transporting up to 10 kilograms.

PS0112X
U CONNECTION PROFILE

- The edges of the panel are not visible when the cabin system spins thanks to the application of this connection piece.
- The U profile's exterior dimensions will be 22 x 15 mm, with a wall thickness of 1.5 mm.
- It will be used to link U profile-Wall and U profile-Divider Panels.
- Its dimensions are 4.2 x 11 mm. Thick threaded, stainless steel screws are used to fasten it.

SS16X012
LOCK - GRIP

- For doors that open outward, the lock is fastened to the door; for doors that open inward, it is fastened to the fixed panel.
- They are made of 304 quality stainless steel.
- It has a diameter of 40 mm and a length of 140 cm.
- They're compatible with both 12 mm and 18 mm HPL panels.
- It has a latch and dial mechanism.
- The latch turning method is used to lock the interior of the cabinet.
- It has a latch and dial, and with the colored mechanism (red-green) on it, it displays from the outside whether the door is busy or not.
- It is interfered from the outside in case of an emergency.

PS0412X
CORNER CONNECTION PROFILE

- The edges of the panel are not visible when the cabin system spins thanks to the application of this connection piece.
- Size: 30 x 30 mm.
- Compact laminate panels will grab the corner profile on all sides.
- This product attached using 304 grade stainless steel screws with a coarse thread measuring 4.2 x 11 mm.

SS04X012
HINGE-SPRINGLESS

- The flat (Tongue-Groove) style door systems category includes this product.
- Metal pieces'll be composed of stainless steel.
- The hinge covers won't have any visible wings.
- They're compatible with both 12 mm and 18 mm HPL panels.
- 90 mm in height and 70 mm in width.

PS0512X
TOP PANEL PROFILE

- Profiles will be installed on the cabinet system's top, front, and side edges.
- A square profile with dimensions of 50 mm x 45 and a wall thickness of 1.2 mm will be utilized as the header profile.

SS03X012
HINGE-SPRING

- The flat (Tongue-Groove) style door systems category includes this product.
- Metal pieces'll be composed of stainless steel.
- The hinge covers won't have any visible wings.
- They're compatible with both 12 mm and 18 mm HPL panels.
- 90 mm in height and 70 mm in width.

SS01X012
LEG

- The size range is 100-150 mm with a diameter of 27mm.
- It has 52 mm diameter leg cover.
- This accessory's adjustable height ranges from 100mm to 150mm.
- The material will be protected by a 12.5 mm duct in a compact laminate panel.
- The leg foundation will be secured to the ground using 1940 shoes that are attached with stainless screws at at least three distinct spots.

TOP VIEW

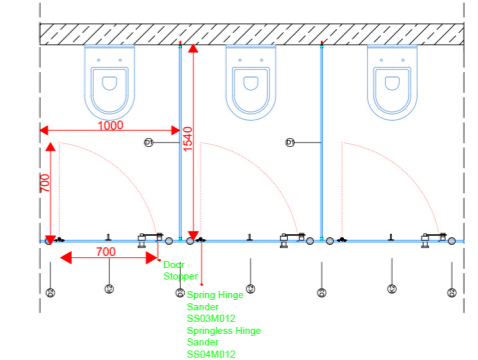

FRONT VIEW

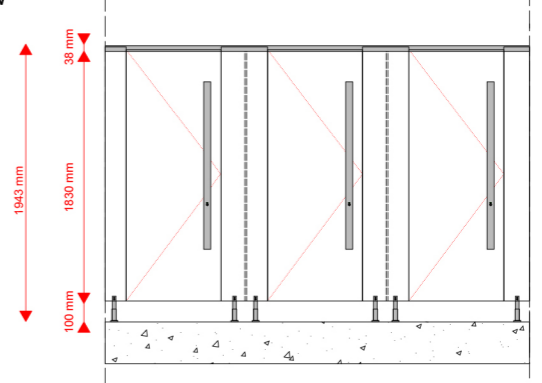

SIDE VIEW

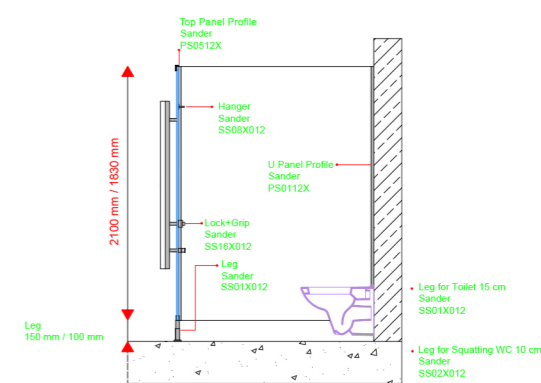

HINGE DETAIL



DOOR DETAIL



LOGO DETAIL



LOCK DETAIL

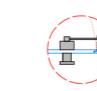

PANELS
The feature is 12 mm Compact laminate panels with double surface decorative, water, scratch, and break resistant, bacteria free, and fire retardant. CGS - CGF EN 438-4 class

LOCK
The door shows if it is busy from the outside by turning the colored mechanism on the latch (TURNED). 304 Quality Stainless Steel.

HINGE
Abs Plastic degree-adjustable and self-closing security screw for single-face (TONGUE-GROOVE SYSTEM) door systems. 304 Stainless Steel

LEG
Anti-bacterial plastic floor connection, 304 Stainless Steel. The adjustable height is 100-150 mm, making it suited for moist regions in general. It aids in adapting to the current slope.

CONNECTIONS AND PROFILES
At junctions, head profiles and "U" profiles 304 Stainless steel, panel-wall, and panel-panel are utilized. Fasteners used in cabinet assembly are all stainless steel.



Accessories



Leg

Product Code - SS01X012

- The size range is 150–200 mm, with a diameter of 27mm.
- This accessory's adjustable height ranges from 150mm to 200mm.
- It has 52 mm diameter leg cover.
- The material will be protected by a 12.5 mm duct in a compact laminate panel.
- The leg foundation will be secured to the ground using PA6 shoes that are attached with stainless screws at at least three distinct spots.
- They're linked to the anti-bacterial plastic floor at three points.
- They're compatible with both 12 mm and 18 mm HPL pannels.
- It has a carrying capacity of 70 kg.
- Water and humidity resistant.



NOT AFFECTED
BY WATER



CORROSION
RESISTANT



MATERIAL 304
STAINLESS STEEL
INOX



0,222 kg

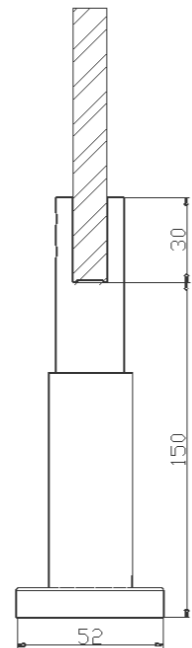

Details matter when it comes to quality.

It is appropriate for wet areas in general and has an adjustable height of 150–200 mm. helps you adjust to the surface's slope.





Leg

Product Code - SS02X012



NOT AFFECTED
BY WATER



CORROSION
RESISTANT

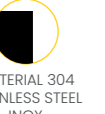

MATERIAL 304
STAINLESS STEEL
INOX

- The size range is 100-150 mm, with a diameter of 27mm.
- This accessory's adjustable height ranges from 100mm to 150mm.
- It has 52 mm diameter leg cover.
- The material will be protected by a 12.5 mm duct in a compact laminate panel.
- The leg foundation will be secured to the ground using PA6 shoes that are attached with stainless screws at at least three distinct spots.
- They're linked to the anti-bacterial plastic floor at three points.
- They're compatible with both 12 mm and 18 mm HPL pannels.
- It has a carrying capacity of 70 kg.
- Water and humidity resistant.



0,278 kg

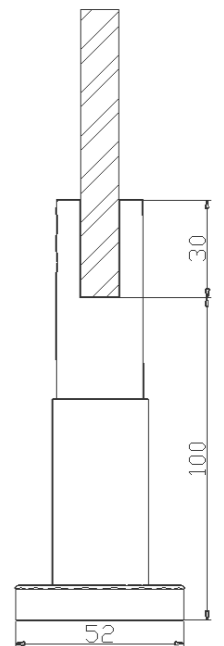



Hinge - Spring

Product Code - SS03X012



NOT AFFECTED
BY WATER



CORROSION
RESISTANT



MATERIAL 304
STAINLESS STEEL
INOX

- The flat (single face) style door systems category includes this product.
- Metal pieces will be composed of stainless steel.
- They're compatible with both 12 mm and 18 mm HPL pannels.
- The hinge covers won't have any visible wings.
- 90 mm in height and 70 mm in width.
- 18 mm. In the nest, it will function.
- It enables the doors to close on their own.
- It has a mechanism with springs.

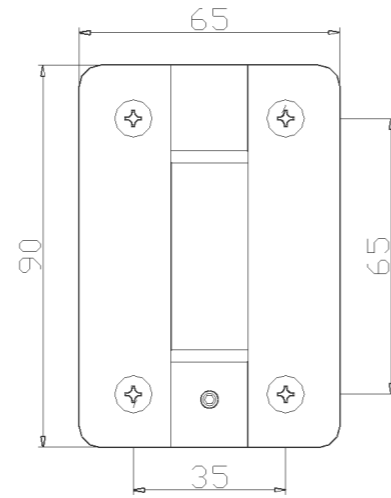
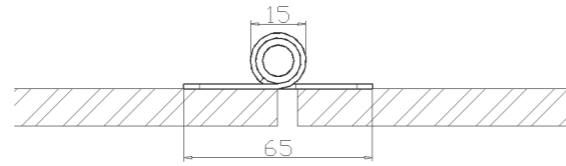
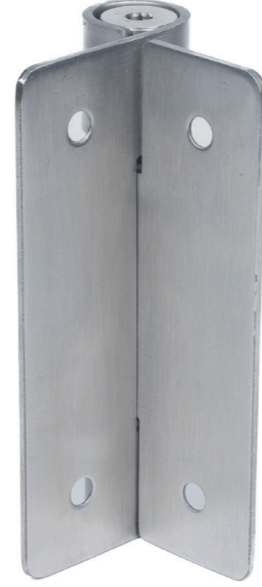

0,220 kg





Hinge - Springless

Product Code - SS04X012



NOT AFFECTED
BY WATER



CORROSION
RESISTANT



MATERIAL 304
STAINLESS STEEL
INOX

- The flat (single face) style door systems category includes this product.
- Metal pieces will be composed of stainless steel.
- They're compatible with both 12 mm and 18 mm HPL pannels.
- The hinge covers won't have any visible wings.
- 90 mm in height and 70 mm in width.
- 18 mm. In the nest, it will function.
- It enables the doors to close on their own.
- It has a mechanism without springs.



0,236 kg



Certificate
CE



Certificate
ISO 9001:2015

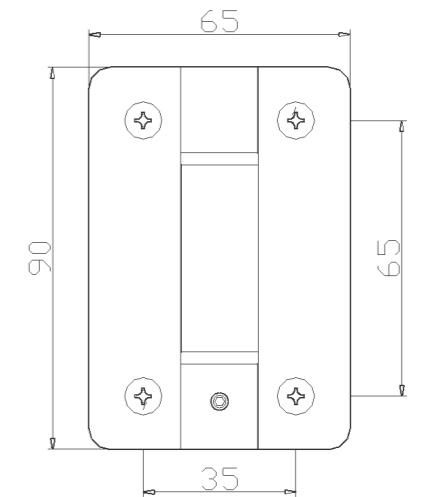
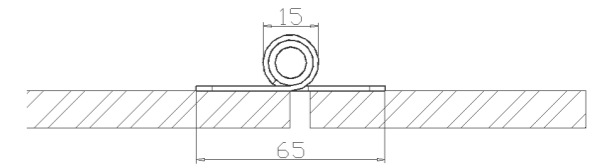

Details matter for comfort.

The hinges to the doors' centers of gravity can be modified appropriately. This method, automated door closure is offered.



Hanger

Product Code - SS08X012

- It's made of 304 quality stainless steel.
- It is corrosion-free within the guarantee term.
- Water and humidity resistant.
- Plastic material is added at the product's end to serve as a stopper and prevent impacts.
- It is capable of transporting up to 10 kilograms.

0,68 kg

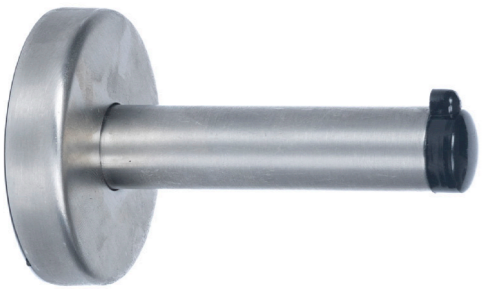
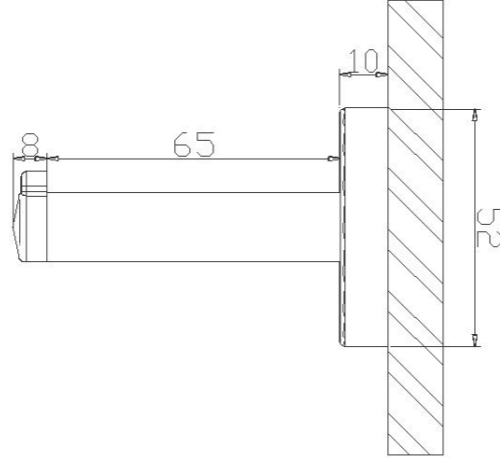

NOT AFFECTED
BY WATER



CORROSION
RESISTANT



MATERIAL 304
STAINLESS STEEL
INOX

Our difference hidden in the details.

The hangers will be held together by YHB 4.2 x 11 mm thick threaded 304 stainless screws.



Lock&Grip

Product Code - SS16P012



NOT AFFECTED
BY WATER



CORROSION
RESISTANT

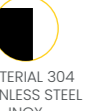

MATERIAL 304
STAINLESS STEEL
INOX

- For doors that open outward, the lock is fastened to the door; for doors that open inward, it is fastened to the fixed panel.
- They are made of 304 quality stainless steel
- It has a diameter of 40 mm and a length of 140 cm.
- They're compatible with both 12 mm and 18 mm HPL pannels.
- It has a latch and dial mechanism.
- The latch turning method is used to lock the interior of the cabinet.
- It has a latch and dial, and with the colored mechanism (red-green) on it, it displays from the outside whether the door is busy or not
- it is interfered from the outside in case of an emergency.

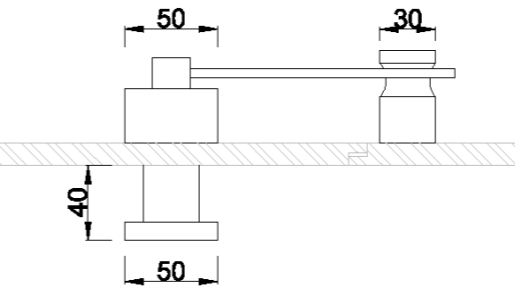

Dashboard



Longevity is in the details.

It is an inox profile designed to connect the panels to the wall and other panels.



Inox Corner Connection Profile

Product Code - PS0412X

- The edges of the panel are not visible when the cabin system spins thanks to the application of this connection piece.
- Size: 30 × 30 mm.
- Compact laminate panels will grab the corner profile on all sides.
- This product attached using 304 grade stainless steel screws with a coarse thread measuring 4,2 x 11 mm.

183 cm

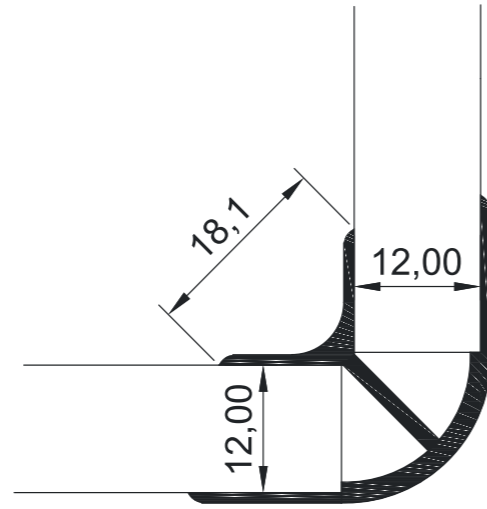

The details provide resistance against time.

The corners are made of 304 stainless steel and are rounded with an R15 radius.

Details determine longevity.

Made with inox profile to fasten panels to walls and other panels.



Inox U Pannel Connection Profile

Product Code - PS0112X

- The edges of the panel are not visible when the cabin system spins thanks to the application of this connection piece.
- The U profile's exterior dimensions will be 22 x 15 mm, with a wall thickness of 1.5 mm.
- It will be used to link U profile-Wall and U profile-Divider Panels.
- Its dimensions are 4.2 x 11 mm. Thick threaded, stainless steel screws are used to fasten it.

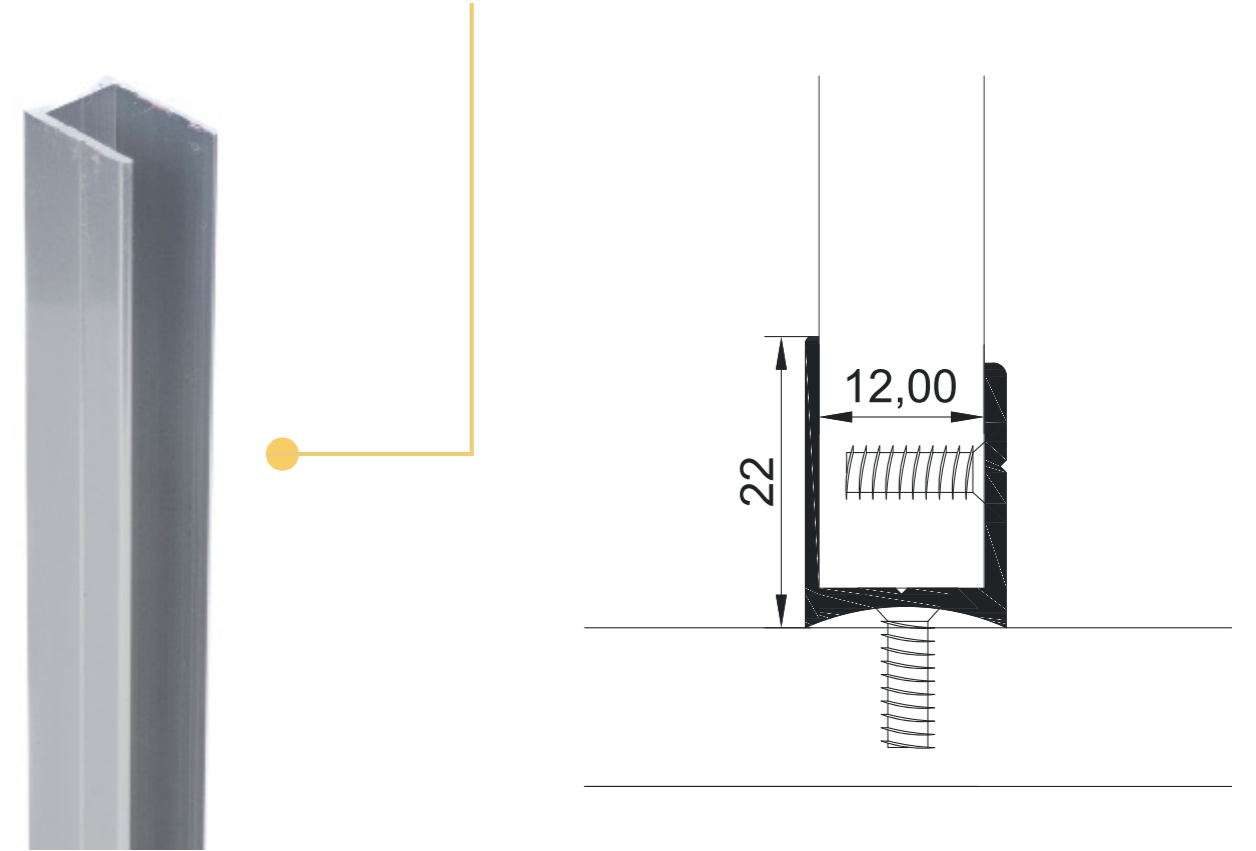



Top Pannel Connection Profile

Product Code - PS0512X

- Profiles will be installed on the cabinet system's top, front, and side edges.
- A square profile with dimensions of 50 mm x 45 mm and a wall thickness of 1.2 mm will be utilized as the header profile.

300 cm

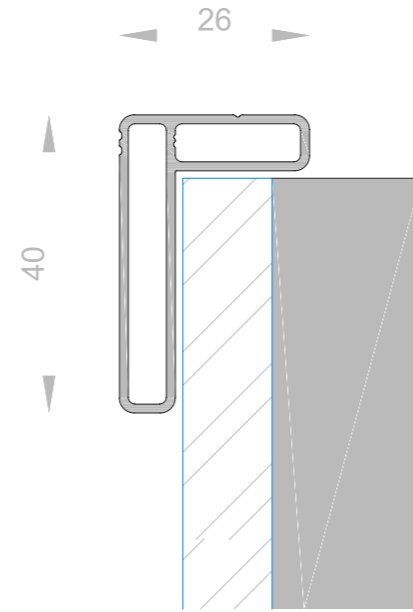

The details determine the appropriate accessory.
Using 3.9x25 screws inserted from the top, the head profile is secured to the panels.

Stock Colors

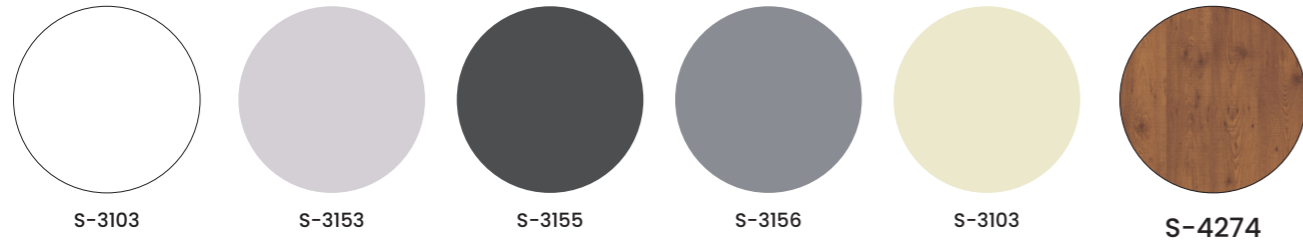

It is possible to prefer static paint with RAL color chart code for accessory products.



Solid Colors (Out of Stock Production Process 4-8 weeks)

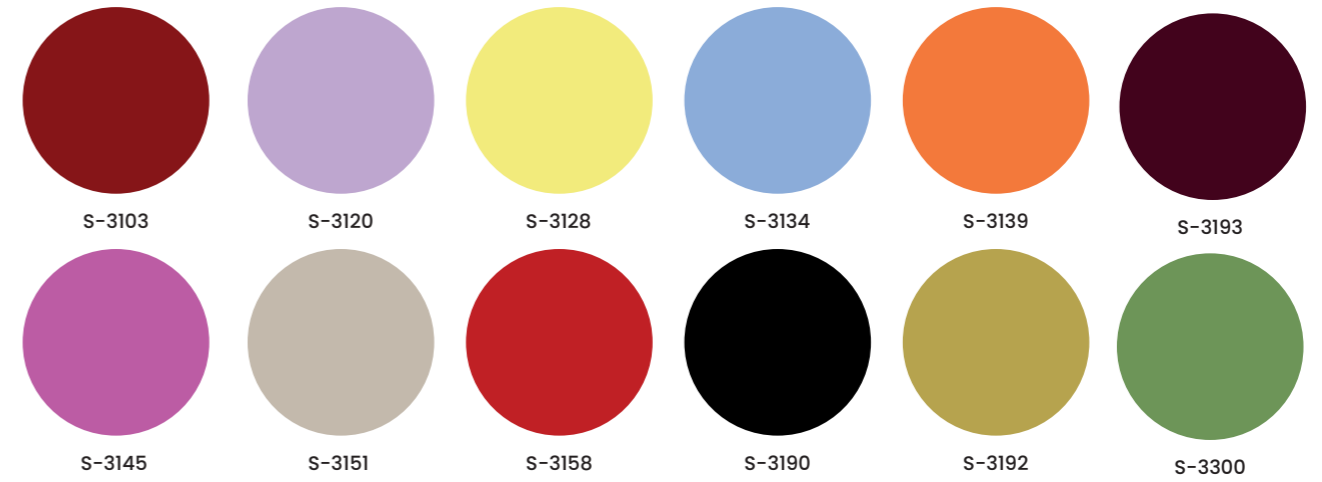

Wood Colors (Out of Stock Production Process 4-8 weeks)

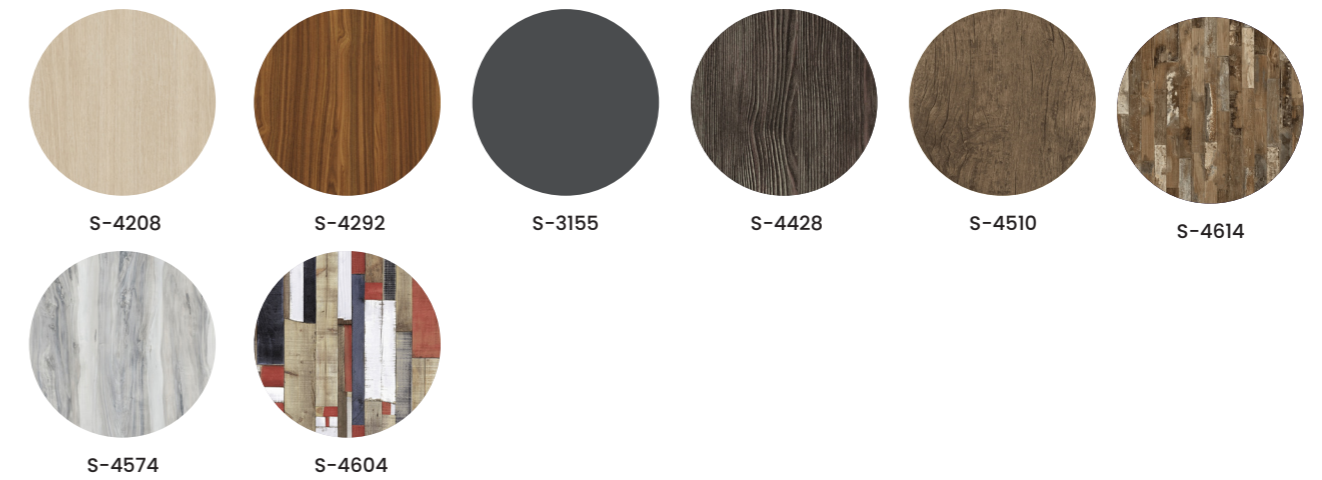

Marble Pattern Colors (Out of Stock Production Process 4-8 weeks)

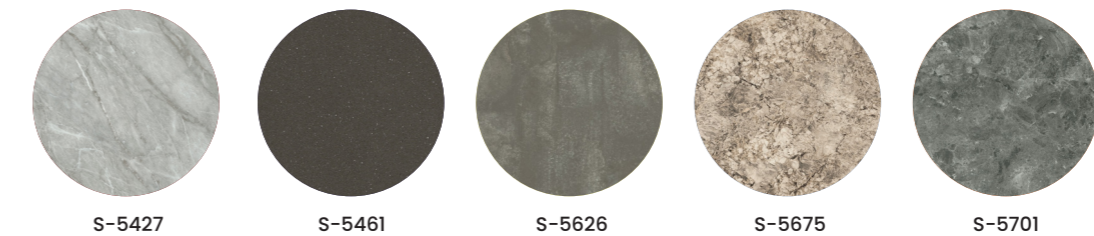

Product Care

Why is maintenance necessary?

It is critical to maintain stainless surfaces in order to maximize product life and corrosion resistance.

What supplies are needed?

This is simply accomplished by dampening a clean cloth in warm water with a tiny bit of detergent or soap.

How to care?

To begin, use a wet cloth to remove coarse grit and grime from the product to be cared for.

Next, thoroughly rinse your cloth. Wiping effectively requires gently rubbing the substance or ingredients.

Attention!

Product maintenance should not be performed using carbon steel brushes or wool wire.



Product Warranty

Warranty

For two years, SANDER guarantees all of its products against corrosion and mechanical flaws.

(*) Our organization accepts no liability in the following situations:

Failure to follow assembly instructions,

In the case of wear and tear caused by maintenance mistakes, in the case of loss or damage caused by user errors, in the case of incorrect disassembly, removal, or replacement, and in the transportations used to carry the product from one location to another.

()** The right to change

SANDER retains the right to make modifications to standard product features and dimensions without previous notification in order to adhere to the idea of always enhancing service quality.

SANDER

From Turkey to the World, with environmental, ecological, and national values...



SANDER

Adding values to your living spaces



Contact Us

0850 255 39 55

SALES OFFICE

Regus Ofis Park
Merkez Mah. Baęlar Cad. No:14
C2 Blok Zemin Kat, 34406
Kaęthane İstanbul, Türkiye

✉ teklif@sander.com.tr

🌐 www.sanderkabin.com.tr



FACTORY

Mehmet Akif Mah.
Petrol Yolu Cad. No:212 A
Sultanbeyli, İstanbul Türkiye

✉ info@sander.com.tr

🌐 www.sander.com.tr